

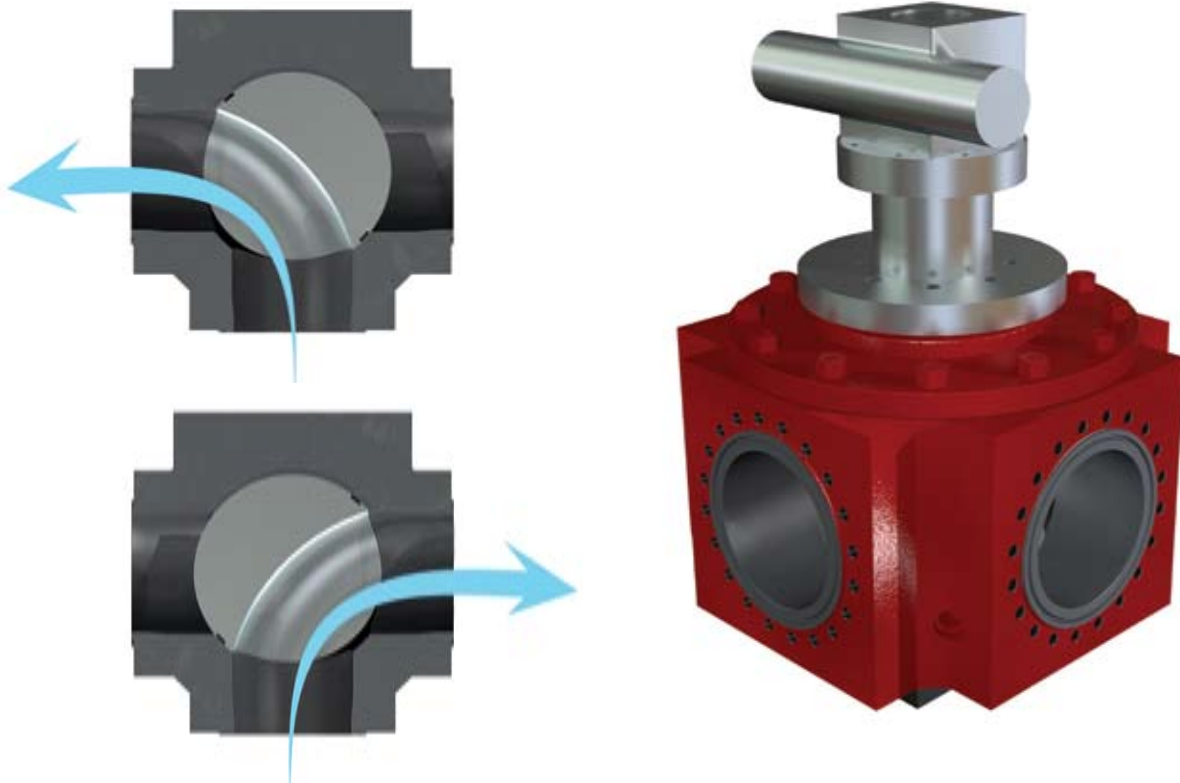

Flow Selector

Ensure Downwind Gas Diversion Every Time

Pressure Control Equipment: Diverters



APPLICATIONS & BENEFITS

The Flow Selector is a rugged switchable target designed to always keep the diverter discharge line open. It replaces a target and two valves which can be shut-in unintentionally and can restrict flow area. The Flow Selector also eliminates parts and controls sequencing to reduce the potential for malfunction. This product:

- Always remains open to a preselected position for downwind overboard discharge to port or starboard. An inlet and two outlets with a hydraulically actuated plug allow for choice in flow direction.
- Is designed specifically for diverter applications. It will improve system performance on any rig, new or old.
- Comes in two sizes for use in either a 12" or 16" diverter vent line.

ENGINEERING DATA

System Of Measure	U.S.	Metric	U.S.	Metric
Bore Size	12.00 inches	305 mm	16.00 inches	406 mm
Pressure Rating	720 psi	50 bars	720 psi	50 bars
Actuator Pressure	1,500-3,000 psi	103-207 bars	1,500-3,000 psi	103-207 bars
Actuator Fluid Volume	0.75 gal	2.7 L	0.75 gal	2.7 L
Weight (With Actuator)	5,250 lbs	2,382 kg	7,500 lbs	3,403 kg
Studded Faces (All Three)	12.00 inches ANSI 300	12.00 inches ANSI 300	16.00 inches ANSI 300	16.00 inches ANSI 300

KEY FEATURES

The Flow Selector is widely used on rigs supplied with Hydril diverters and also with equipment from other manufacturers. It enhances efficiency by eliminating diverter valves and provides long-lived safety benefits because:

- **It eliminates the possibility of system shut-in** because the vent path is always open. There is no closed position.
- **It provides a hardened steel target**, resists erosion and provides long flow life.
- **It operates in any physical orientation.**
- **It can be mounted directly to the rig structure**, to support vent line piping.

THE FLOW SELECTOR ADVANTAGE

By eliminating the possibility that dangerous gas flows will not be vented, the Hydril Flow Selector ranks among the most effective safety enhancements you can make—for any offshore rig.

